

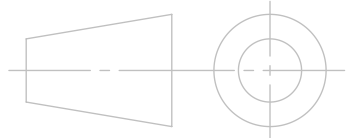

The St. Louis Science Centre Planetarium's exterior curved surface is in the shape of a **hyperboloid of revolution**. This shape is formed by revolving a **hyperbola** around its axis.

The drawing below shows an incomplete elevation of the planetarium. The line VV represents the **transverse axis** of the **double hyperbola** and P and Q are points on the curve.

Complete the elevation by constructing the double hyperbola.

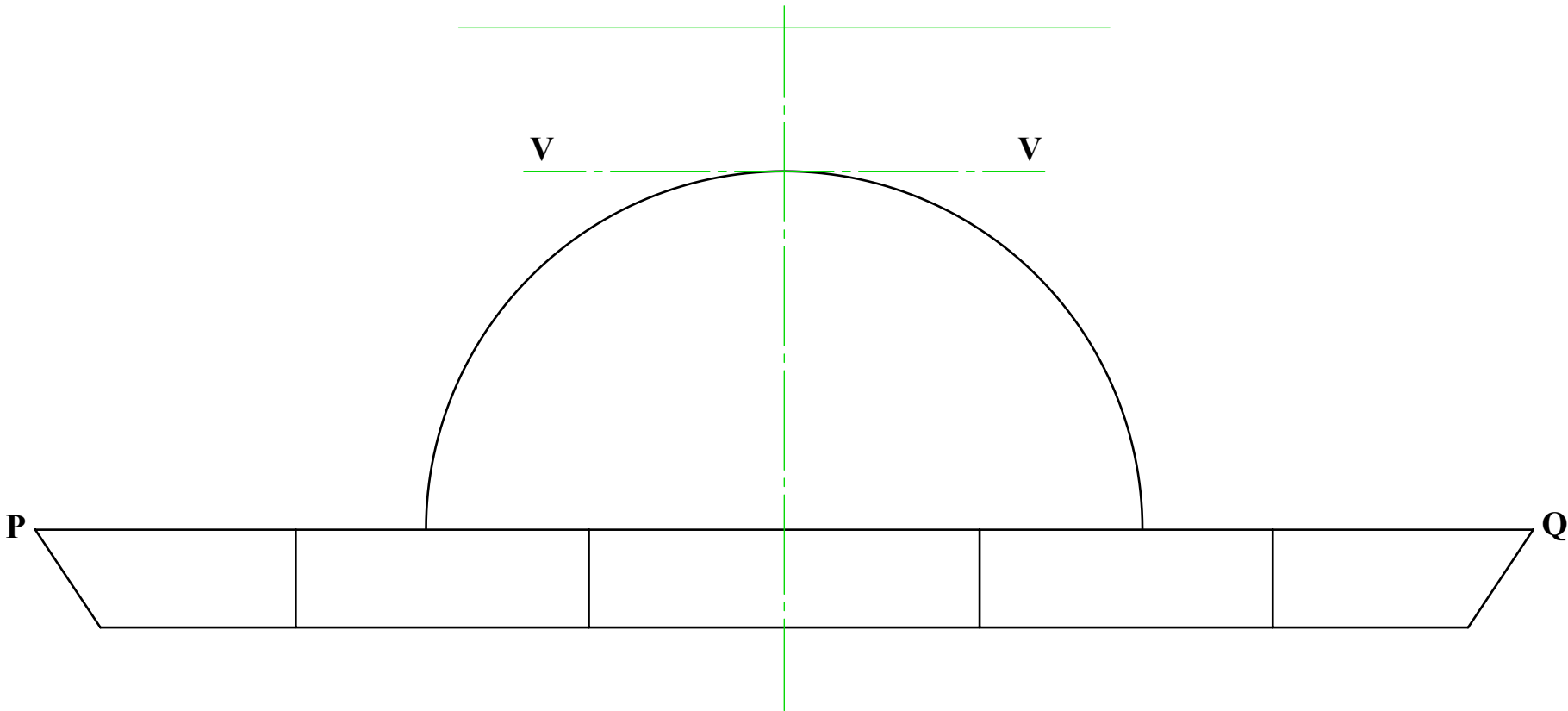

DESIGN & COMMUNICATION GRAPHICS

TITLE: **CONIC SECTIONS 2**

DRAWN BY:

SIZE
A3

UNLESS OTHERWISE SPECIFIED ALL
DIMENSIONS ARE IN mm

SCALE: 1:1

DATE: 26/01/2009

SHEET 1 OF 1